

Mono Basin mixer installation instructions

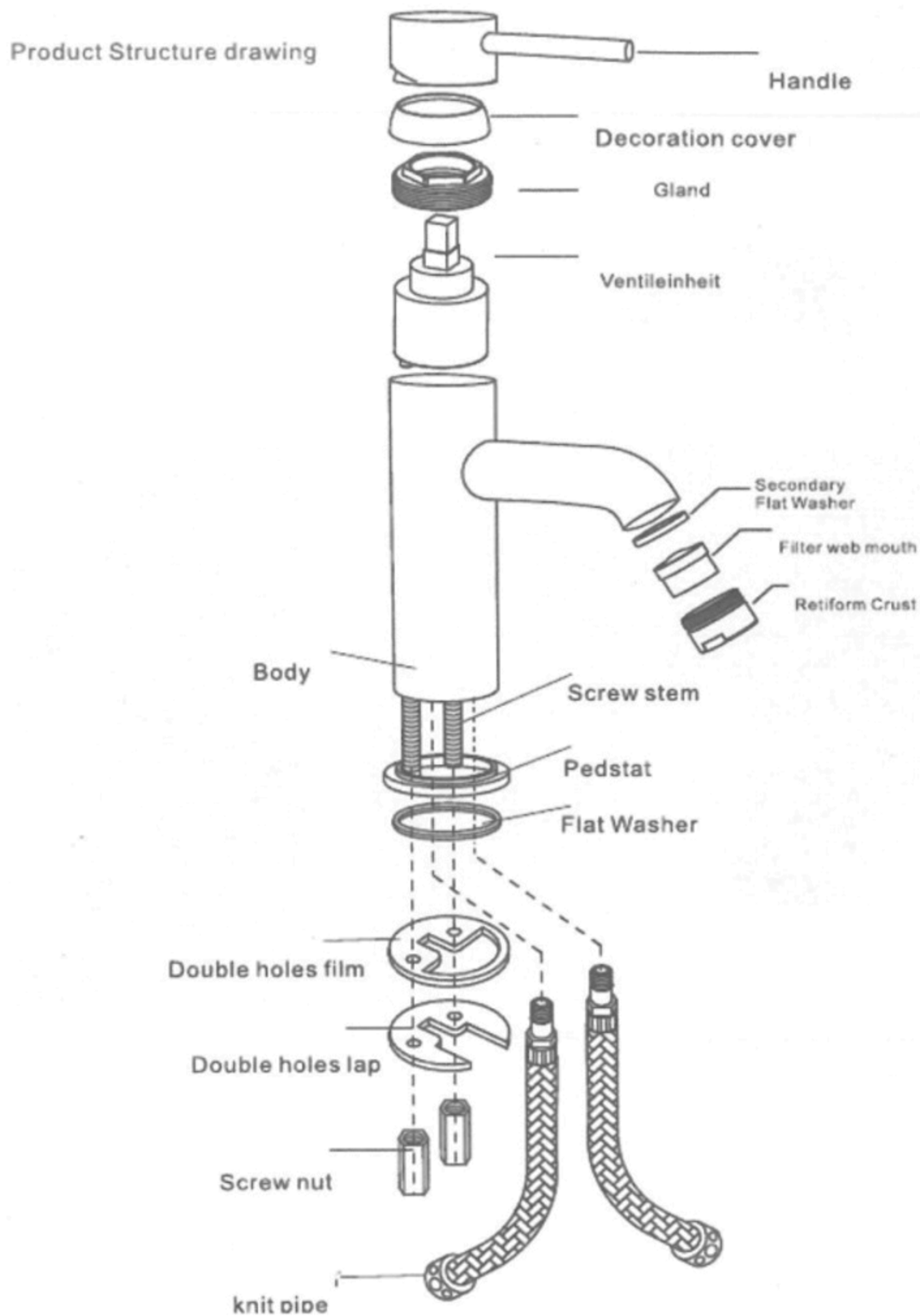

INSTALLATION OF 2 IN 1 WC & BASIN

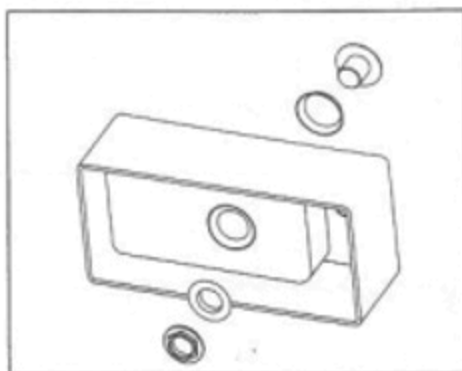

Step 1: Place and fix the waste and washer.

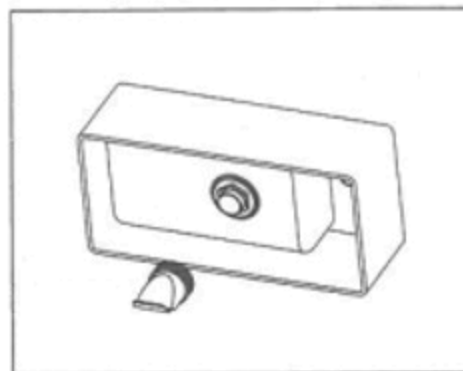

Step 2: Fit the Silicone sleeve on the bottom of the waste.

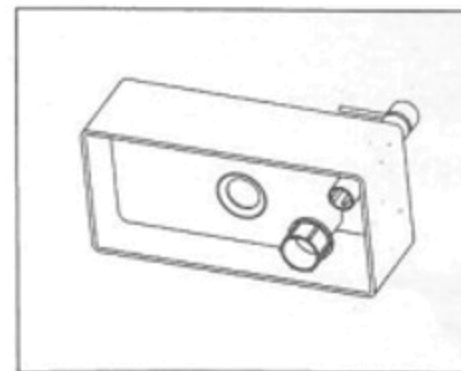

Step 3: Place the tap and tightly screw the fixing nut.

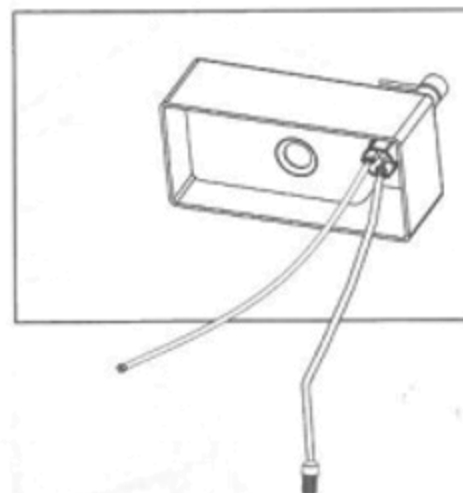
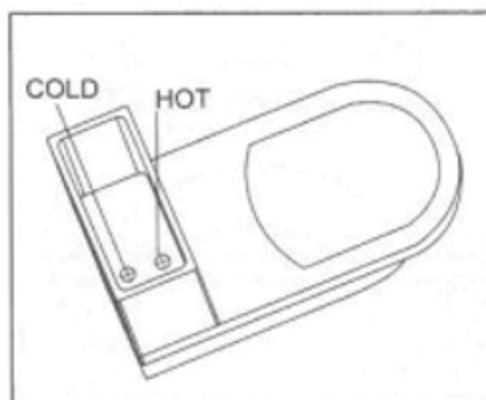

Step 4: Connect hot & cold water hose to the tap and connect the other end to outlet of the cistern.

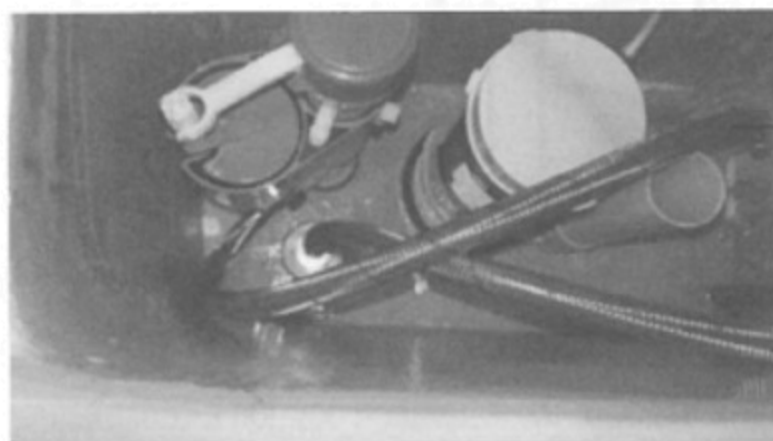

Cold water

Warm water

INSTALLATION OF WASH BASIN



Note: During installation, please ensure there is enough distance between the float of the inlet valve and the hoses, make sure there is no resistance to the normal operation of the inlet valve.

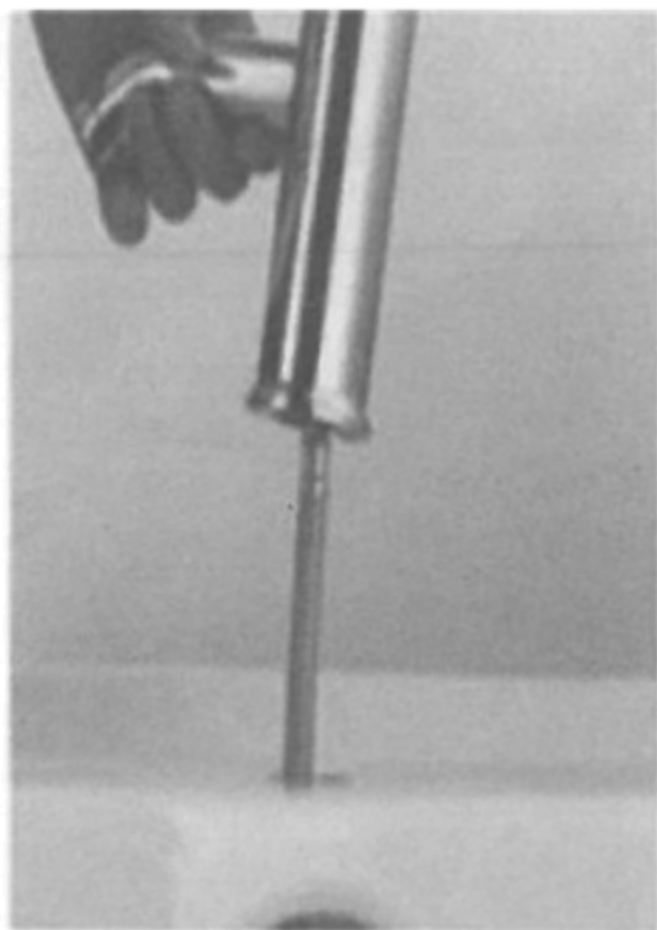

1, Fixed with one of flexi pipe



2, Fixed fix 2nd pipe with the flim and lap at the bottom



3, Tigten the lap and back nut

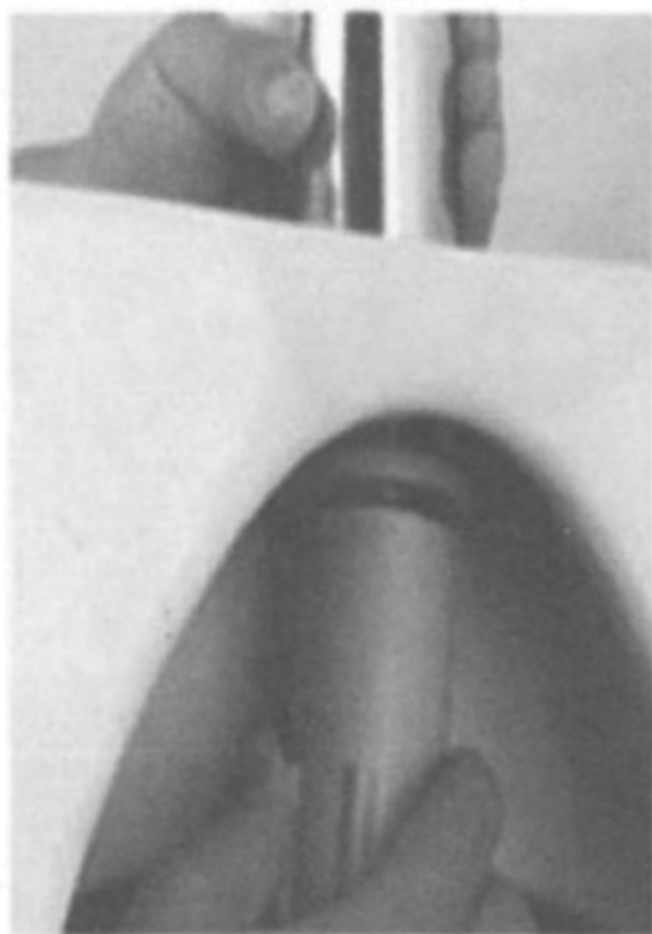

4, Tigten the cover

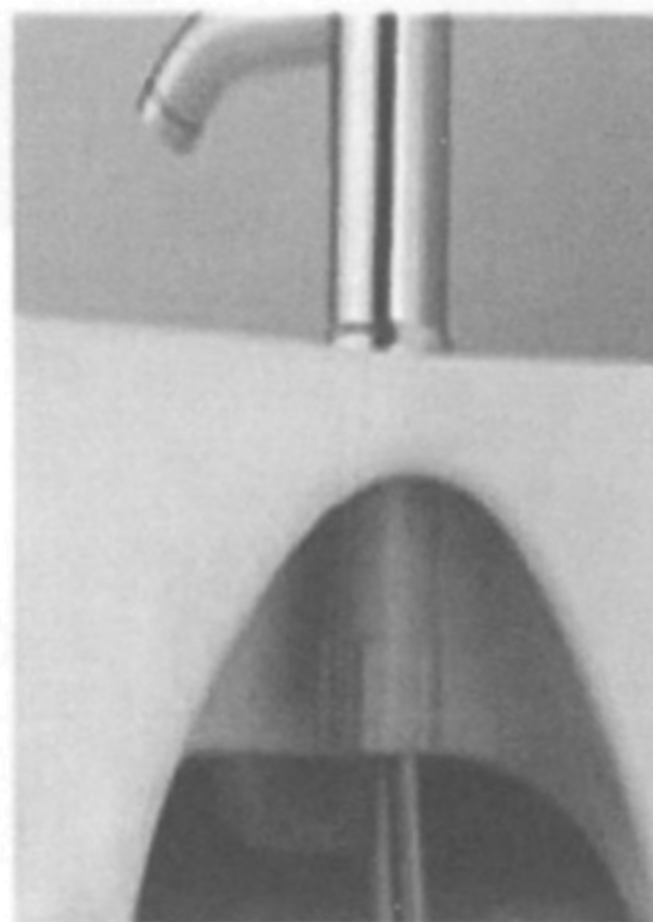

5, Finished